

**PRODUCT SPECIFICATIONS**

Elkay Explore Single Hole Kitchen Faucet with Pull-down Spray and Forward Only Lever Handle. Faucet has a flow rate of 1.8 GPM, and is made of Brass material, with a Ceramic Disc valve. Faucet requires 1 faucet holes.

|                                |                                       |
|--------------------------------|---------------------------------------|
| <b>Mounting Type:</b>          | Deck Mount                            |
| <b>Special Features:</b>       | Solid Brass Construction              |
| <b>Spray Type:</b>             | Pull Down                             |
| <b>Finish:</b>                 | Chrome (CR), Lustrous Steel (LS)      |
| <b>Handle Type:</b>            | Forward Only Lever Handle             |
| <b>Deck Clearance:</b>         | 7-5/16"                               |
| <b>Spout Reach:</b>            | 9-3/8"                                |
| <b>Spout Height:</b>           | 16-1/16"                              |
| <b>Hole Drillings:</b>         | 1                                     |
| <b>Material:</b>               | Brass                                 |
| <b>Valve Type:</b>             | Ceramic Disc                          |
| <b>Valve Connection:</b>       | 3/8" Female Compression Hose Assembly |
| <b>Flow Rate:</b>              | 1.8 GPM                               |
| <b>Faucet Hole Size (min):</b> | 1-1/2"                                |
| <b>Countertop Thickness:</b>   | 3                                     |
| <b>Spout Swing Rotation:</b>   | 360°                                  |
| <b>Spout Type:</b>             | Pull-down Spray                       |
| <b>Spray Functions:</b>        | Aerated, Nylon Hand Spray Hose, Spray |



**Included with Product:**      **Optional Deck Plate/Escutcheon included**

A Century of Tradition and Quality. For more than 100 years, Elkay has been making innovative products and providing exceptional customer care. We take pride in offering plumbing products that make life easier, inspire change and leave the world a better place.

**Product Compliance:**      ADA & ICC A117.1  
ASME A112.18.1/CSA B125.1  
CEC  
NSF 372 (lead free)  
NSF 61



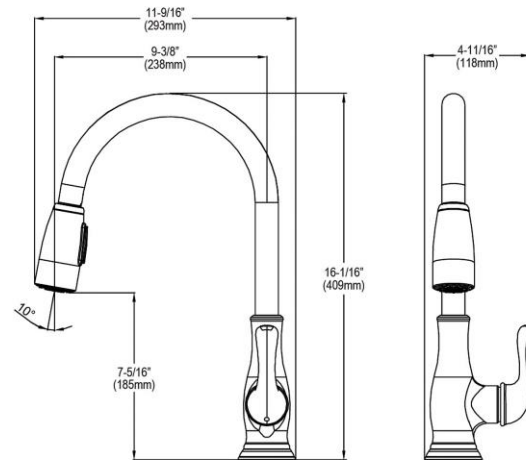

Complies with ADA & ICC A117.1 accessibility requirements when installed according to the requirements outlined in these standards.

[Clean and Care Manual \(PDF\)](#)  
[Installation Instructions \(PDF\) - LKEC2041 - Install Sheet](#)  
[Warranty \(PDF\)](#)



PART: \_\_\_\_\_ QTY: \_\_\_\_\_  
PROJECT: \_\_\_\_\_  
CONTACT: \_\_\_\_\_  
DATE: \_\_\_\_\_  
NOTES: \_\_\_\_\_  
APPROVAL: \_\_\_\_\_

*In keeping with our policy of continuing product improvement, Elkay reserves the right to change product specifications without notice. Please visit [elkay.com](http://elkay.com) for the most current version of Elkay product specification sheets. This specification describes an Elkay product with design, quality, and functional benefits to the user. When making a comparison of other producers' offerings, be certain these features are not overlooked.*

| Optional Accessories  |  |   |
|-----------------------|--|---|
| <a href="#">LK134</a> | Elkay 3-Hole Deck Plate/Escutcheon<br><a href="#">Spec Sheet (PDF)</a>                       |  |
| <a href="#">LK321</a> | Elkay 1-15/16" x 2-5/8" x 2-5/8" Soap / Lotion Dispenser<br><a href="#">Spec Sheet (PDF)</a> |  |

*In keeping with our policy of continuing product improvement, Elkay reserves the right to change product specifications without notice. Please visit [elkay.com](http://elkay.com) for the most current version of Elkay product specification sheets. This specification describes an Elkay product with design, quality, and functional benefits to the user. When making a comparison of other producers' offerings, be certain these features are not overlooked.*

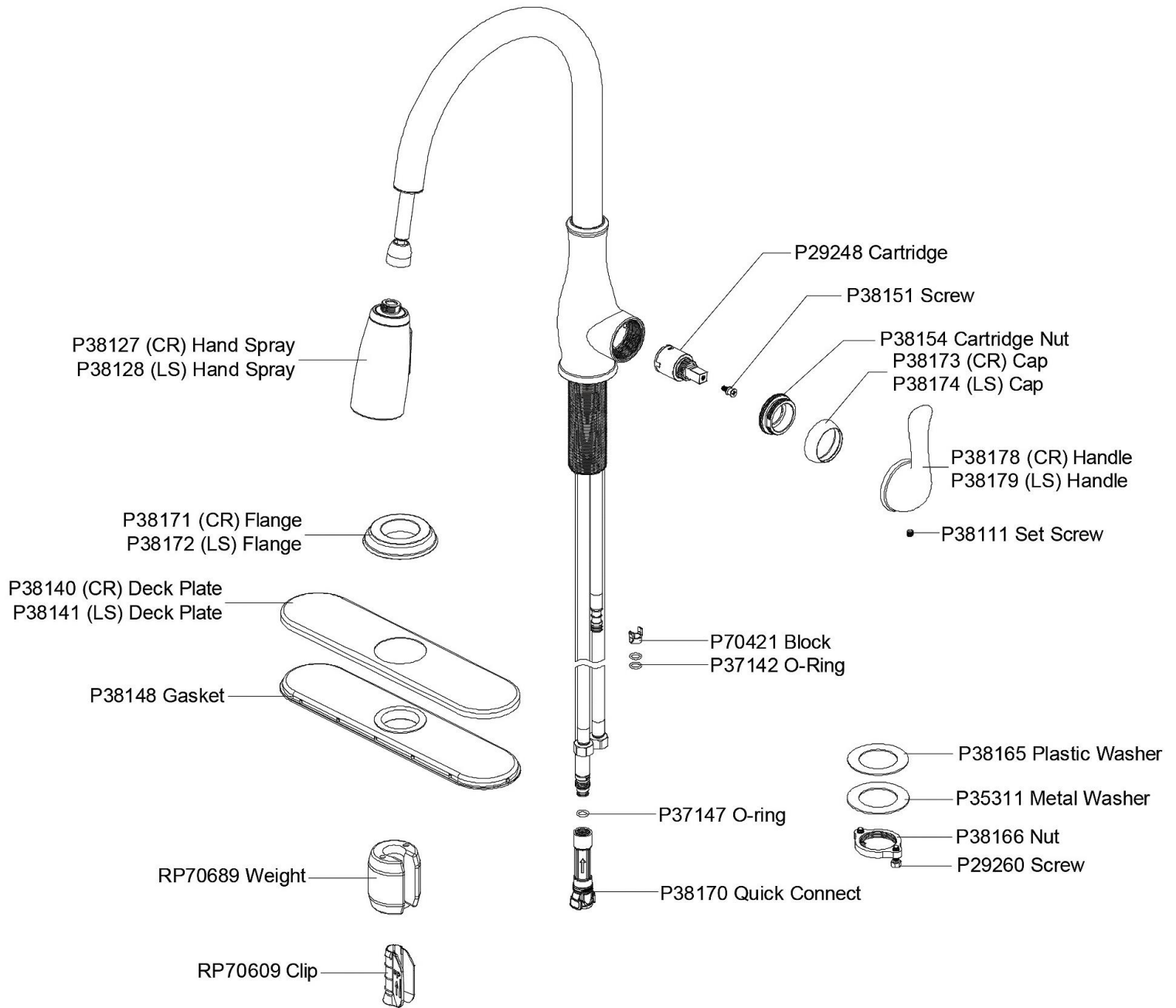

*In keeping with our policy of continuing product improvement, Elkay reserves the right to change product specifications without notice. Please visit [elkay.com](http://elkay.com) for the most current version of Elkay product specification sheets. This specification describes an Elkay product with design, quality, and functional benefits to the user. When making a comparison of other producers' offerings, be certain these features are not overlooked.*